

# Tower2塔架

升降塔架2是一款重型插销式桁架系列，上升高度能达到12米的高度，并能够承重2000kgs重量。由于具有高承重和更长跨度这些性能，它们能够在大型结构中完美地使用。

Tower 2 is a heavy duty tower from quick-lock line segments that can go up to 12m and its loading capacity is 2000kgs. Thanks to its characteristics very well in large scale structures with high loads and longer spans.

## 配件清单 Part List

TG BP	1PCS
TG SB	1PCS
ST5029-H	4PCS
TG TS	1PCS
TG LO	4PCS
TT44-1000	1PCS
TT44-2000	4PCS
TT44-3000	1PCS

## Specification 规格

Self weight	315kgs
Height	12m
Load capacity	2000kgs

## Mast section TT44

Main tubes	50x4mm
Barces	25x3mm
Alloy	EN-AW6082T6

### TG BP

钢铁底座  
Steel base plate

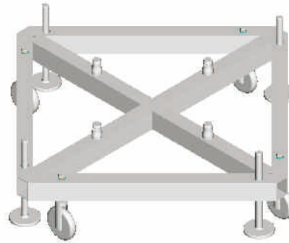

### TG SB

套筒座  
Sleeve block

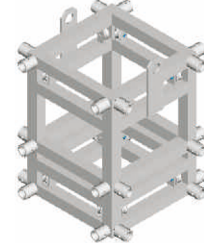

### TG TS

横担  
Top section

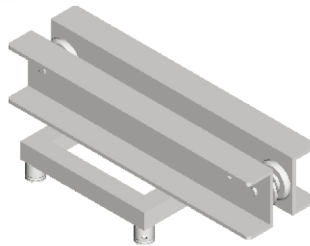

### TG LO

支撑架  
Long outrigger



### ST5029-H

铰链部分  
Hinge section

